

DMD
COLLECTIVE

DMD103BLK

Smart Corner Lamp

Information for use

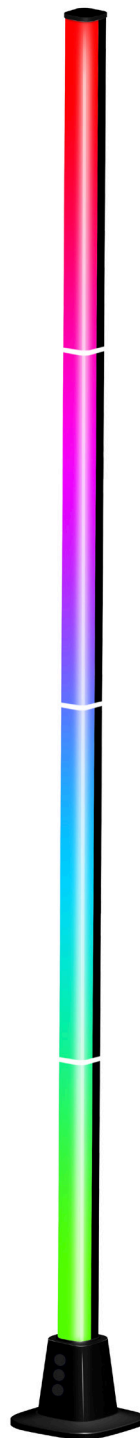

Thank you for purchasing the DMD Collective Smart Corner Lamp. The Smart Floor Lamp is a fun electronic gadget with 16 million colour effects that allows you to personalise lighting and create the ideal ambiance in any space. Whether you desire a relaxing setting or an energetic party atmosphere, this gadget can provide it. Control the lamp with the buttons, the Smart Life App, or voice-activated devices such as Alexa or Google Home. Choose to set up between 1-3 lamp bodies on the lamp base, then adapt the colour, modes, and settings to best suit your environment.

Components Supplied

1. Lamp with base x 1
2. Lamp body x 3
3. Plastic cap for lamp body x 1
4. Cable with adaptor x 1
5. Installation Manual x 1

This product is simple to set up. It has four aluminium bodies that clip into a lamp base. You may attach any number of lamp bodies onto the bases at once, ranging from 1-4 blocks.

Notice: For safety, please power off when assembling or disassembling. And be careful not to break the pins.

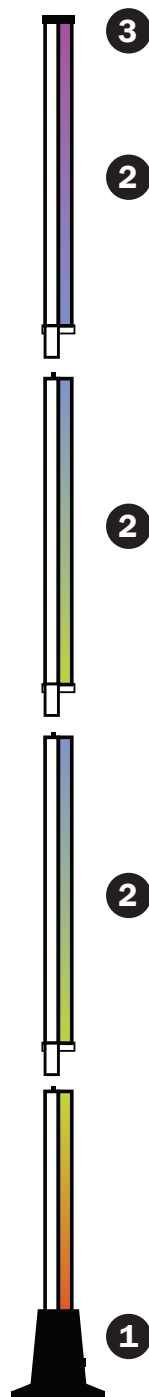

Health and Safety Guidelines

- For indoor use only. This product works best in a dark environment.
- Always unplug the unit when not in use, before cleaning, or when adding or removing parts.
- Please read the instructions carefully before using any appliance.
- Always ensure that the voltage on the rating label corresponds to the mains voltage in your home.
- Incorrect operation and improper use can damage the appliance and cause injury to the user.
- The appliance is intended for household use only. Commercial use invalidates the warranty, and the supplier cannot be held responsible for injury or damage caused when using the appliance for any other purpose than that intended.
- Do not let children use this appliance unsupervised.
- Check the power cord and plug regularly for any damage. To prevent an electrical hazard, the manufacturer will need to replace the cord or plug if it is damaged.
- Do not use the appliance if it has been dropped or damaged in any way. If the unit is damaged, take it in for examination and/or repair by an authorized service agent.
- To reduce the risk of electric shock, do not immerse or expose the motor assembly, plug, or power cord to water or any other liquid.
- Never immerse the unit in water or any other liquid for cleaning purposes. Do not reach for an appliance that has fallen into the water. Unplug immediately.
- Remove the plug from the socket by gripping the plug. Do not pull on the cord to disconnect the appliance from the mains.
- Injury, fire, or electric shock could result from the use of accessory attachments that the manufacturer has not approved or supplied.
- A short cord is provided to reduce the hazards resulting from becoming entangled in or tripping over a longer cord.
- Do not let the cord hang over the edge of a table or counter.
- Ensure that the cord is not in a position where it can be pulled inadvertently.
- Do not allow the cord to touch hot surfaces, and do not place it on or near a hot gas or electric burner or in a heated oven. Do not place the unit on a hot surface.
- Do not use this appliance for anything other than its intended purpose.
- Do NOT carry the unit by the power cord.
- Do not leave this appliance unattended during use. An appliance should never be left unattended when plugged in.
- The manufacturer does not accept responsibility for any damage or injury caused by improper or incorrect use or for repairs carried out by unauthorised personnel.
- In the event of technical problems, switch off the appliance and do not attempt to repair it yourself. Return the appliance to an authorised service facility for examination, adjustment, or repair.
- Always insist on the use of original spare parts. Failure to comply with the above-mentioned precautions and instructions will affect the safe operation of this machine.

Quick Installation Guide

1. Connect the adaptor plug to power.
2. Connect the adaptor port to the lamp base as seen below.

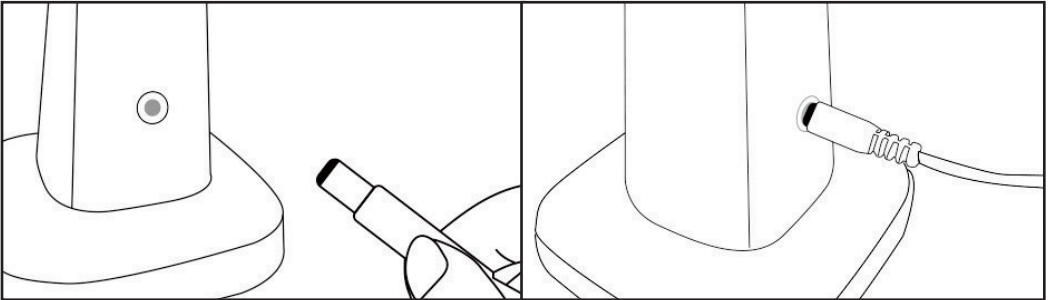

3. Connect the lamp bodies into the lamp base.
4. Enjoy the lamp! You can control the lamp by pressing the lamp base button or via the Smart Life App.

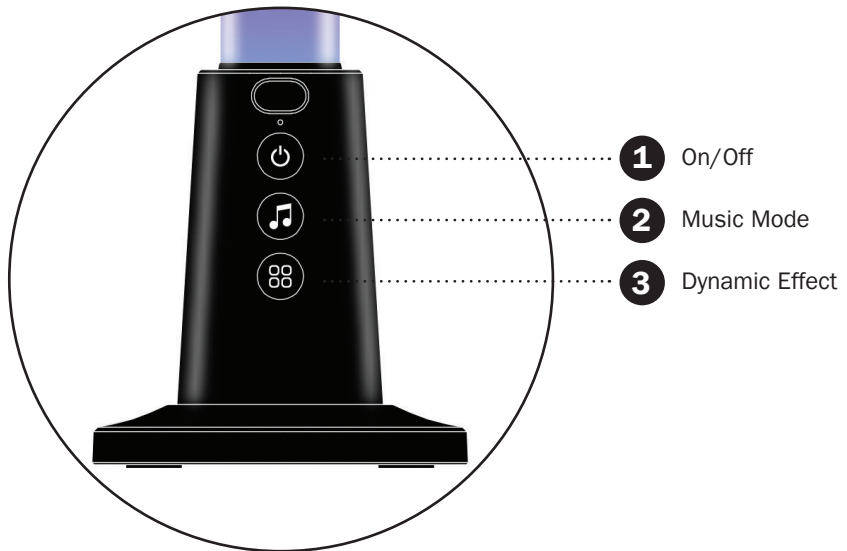

Controlling the Device

1. Power button: Press the power button to turn the lamp on or off. Hold down the power button for 6–10 seconds to make the red-light blink rapidly to configure the network.
2. Local music mode: Press this button to enter the local music mode, and a continuous short button press toggles from rock, jazz, classical, roll, energy, and spectrum cycles.
3. Dynamic effect: Press this button to enter the scene selection mode; continuous short presses enter the action effect switch; it can be pressed 17 times as a cycle (please note: The app does not synchronise showing the changes).

Controlling the Lamp via App

Download the Smart Life App from either the Apple App Store or Google Play. Download or scan the QR code and install the Smart Life App for either iOS or Android. Once downloaded, the app will prompt you to register your device. Enter your phone number or email, whichever is more convenient, and select the country you live in. If you use a phone, you will receive a text with a registration code. If you choose email, you will need to create a password.



Please note: There are two mode configurations (Bluetooth Mode/Quick Mode) available to add the device to the app. Bluetooth Mode is recommended (Need to turn on your phone's WIFI, Bluetooth, GPS first).

Bluetooth Mode Configuration (Common)

1. Turn on your phone's Bluetooth. After the Smart Floor Lamp is powered on, wait for 3-5 seconds to press the Lamp Base On/Off button for 6–10 seconds. until the red light blinks rapidly. Enter the add device interface. It automatically says "Devices to be added," then press "Go to Add." (If the devices can't appear automatically, then you need to add them manually).
2. Enter your Wi-Fi password and press "Next" to add a device. Once connected, the app will prompt you to press "Done."

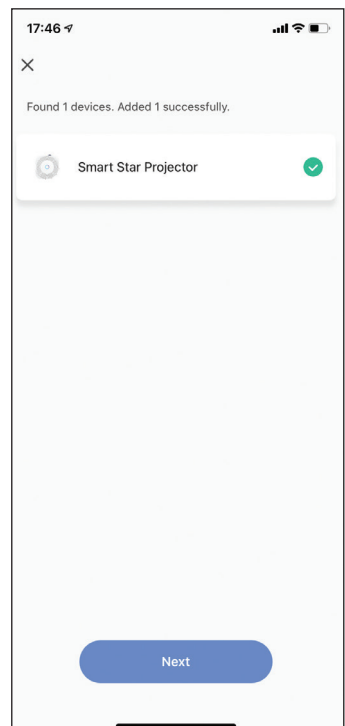
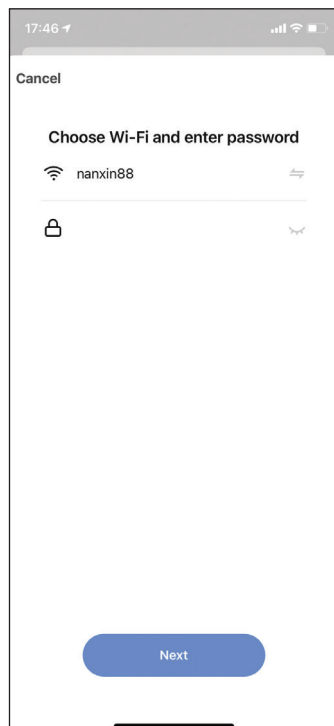
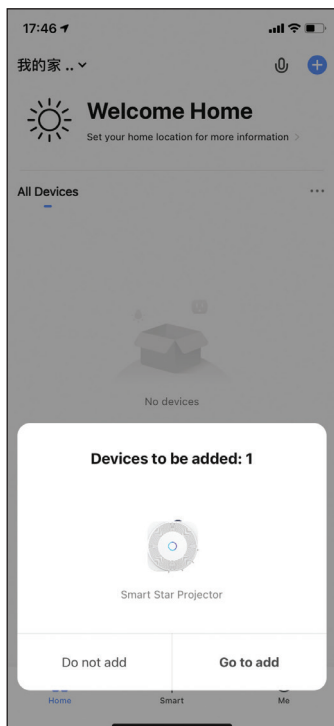

Quick Mode Configuration

1. Make sure quick mode configuration is initiated: The lamp blinks red rapidly (twice per second). If it blinks red slowly (once every 3 seconds), press and hold the power button on the smart floor lamp for 6–10 seconds until it blinks red rapidly.
2. Tap the icon + on the top right, choose any device type, and enter “Add Manually.” (Figures 1 & 2). Choose blink quickly. (Figures 3 & 4).

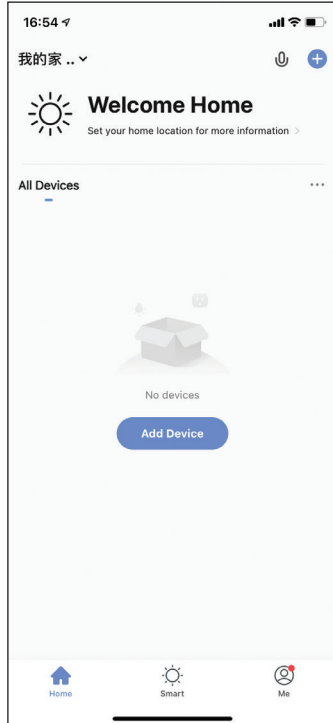

Figure 1

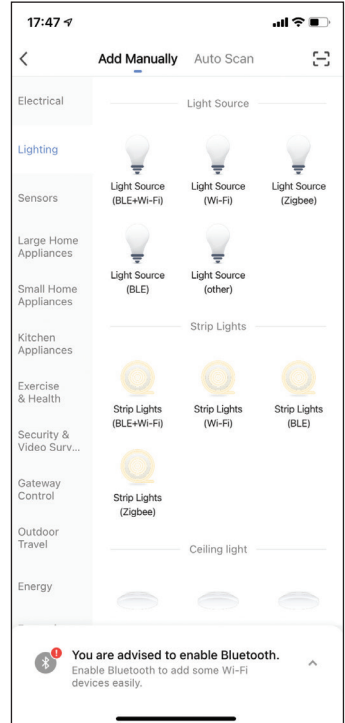

Figure 2

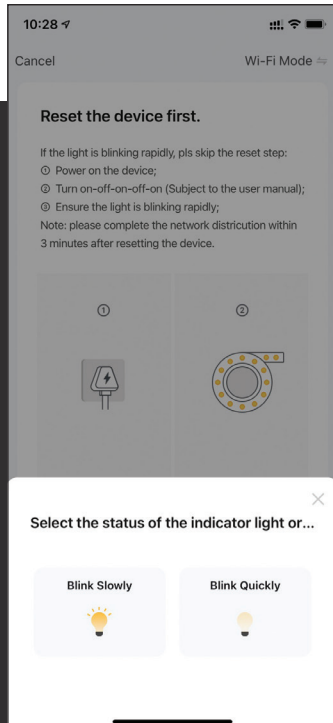

Figure 3

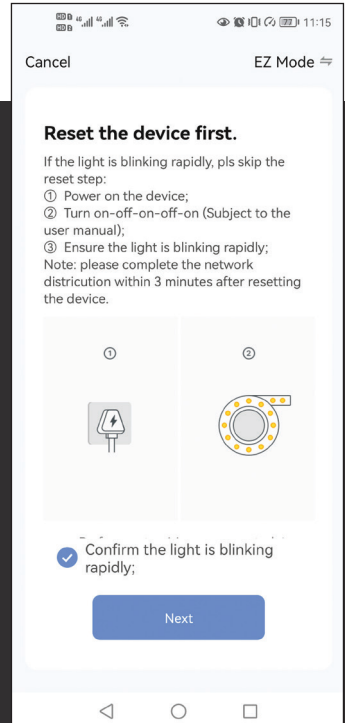

Figure 4

3. Follow up on the in-app instructions to connect the Smart Floor Lamp to your Wi-Fi network
4. Enter your Wi-Fi password and press “Next” to add a device. Once connected, the red light will turn from blinking to solid. (Figures 5 & 6).
5. Once the connection is finished, the app will prompt you to press “Done.” (Figure 7).
6. Now you can control the Smart Corner Lamp through the Smart Life APP (Figure 8) and the device will be added to the “Device List.”

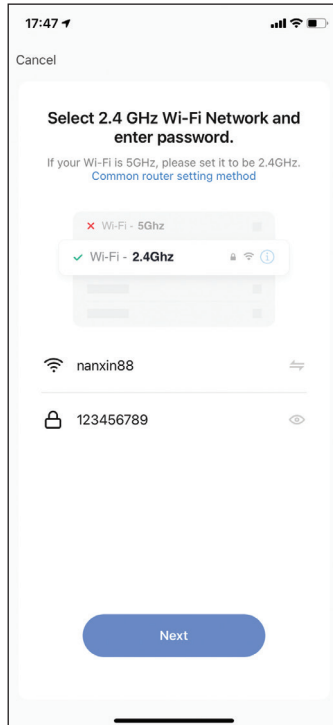

Figure 5

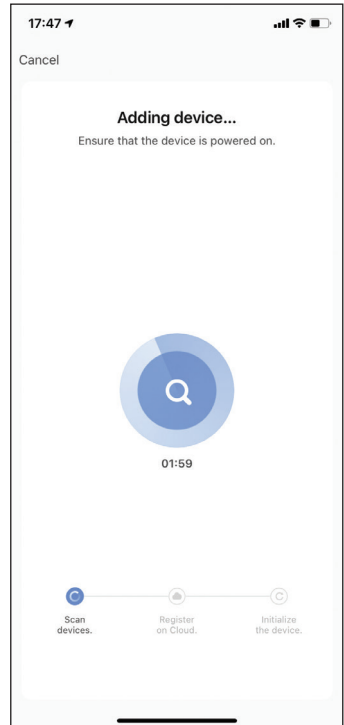

Figure 6

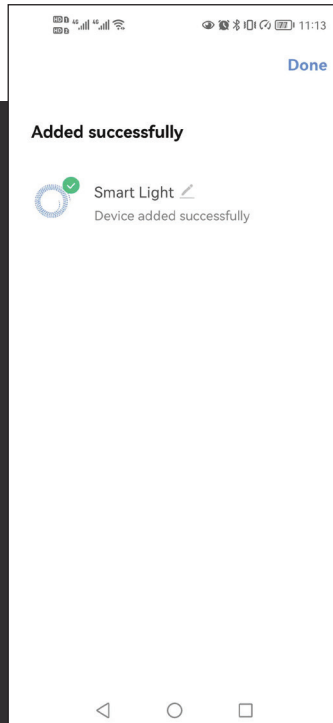

Figure 7

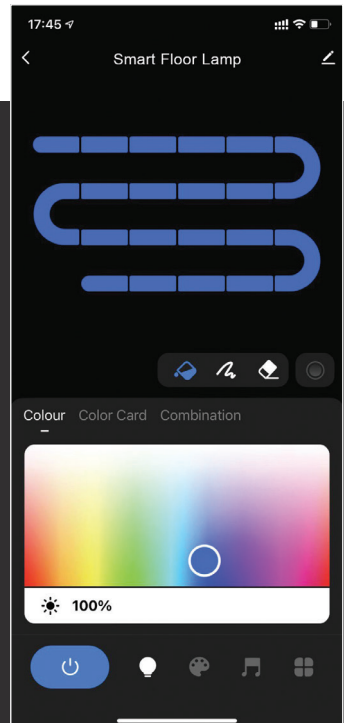

Figure 8

7. If you want to use the lamp body with less than 4 sections lit up, set the corresponding length of the lamp first on the 'Light Strip Length' section to achieve the best lighting effect. (Figures 9 & 10).

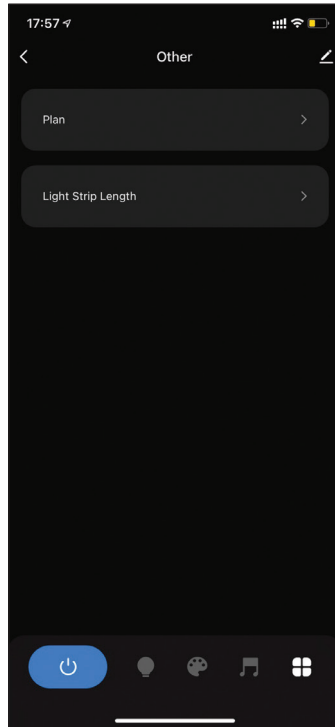

Figure 9

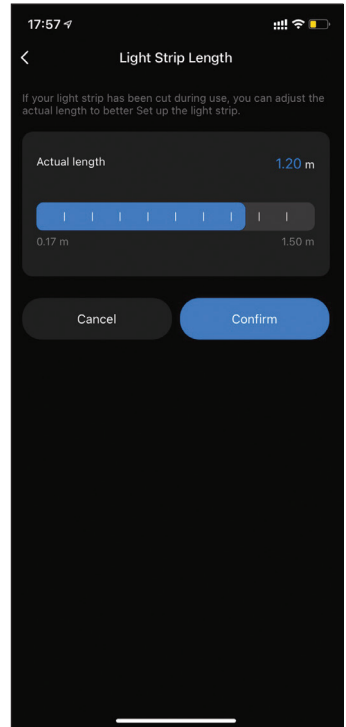

Figure 10

Connect to Amazon Alexa

1. Launch the Smart Life App, sign into your account, and make sure Smart Floor Lamp is on the device list.
2. Download and launch the Alexa App, sign in to your Alexa account, and make sure you have at least one Alexa smart speaker-controlled device installed, like an Echo Dot, etc.
3. Click the 'device' icon at the bottom of the app screen.
4. Inside the device menu, press the + button in the top right corner (Figure 1).
5. On the pop up at the bottom of the screen, select ADD DEVICE.

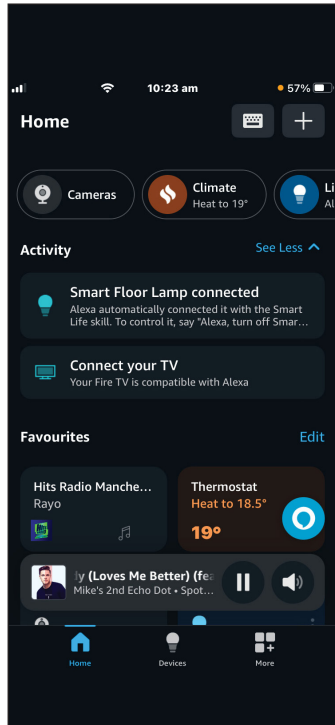

Figure 1

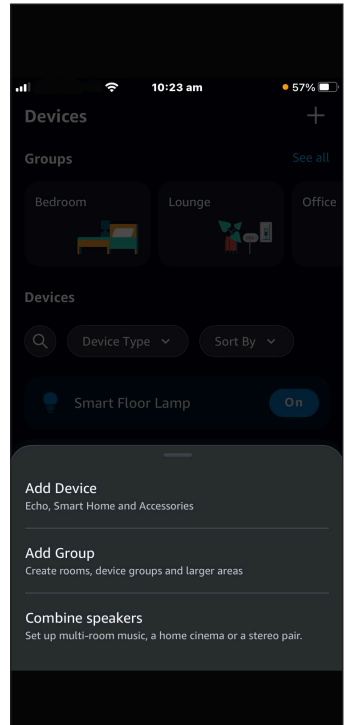

Figure 2

6. On the 'Which device would you like to set up' page, - Select 'Light'.
7. After this, choose 'Smart Life' from the list of Light brands (Figure 4).
8. Follow the on-screen instructions to control the device.

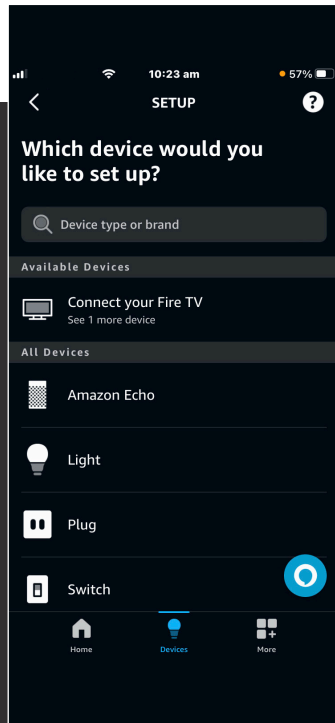

Figure 3

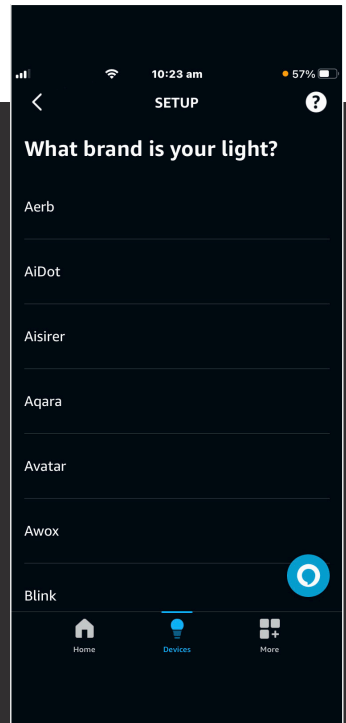

Figure 4

Connect to Google Home

1. Launch the Google Home app and make sure the Google Home speaker is installed. If not, please follow the Google Home speaker installation instructions to complete the installation.
2. Once Google Home speaker is installed, choose 'Add' in the right hand corner, (Figure 1), then choose "Works with Google Home" (Figure 2).
3. On the compatible app options choose the 'Smart Life App' (Figure 3) and login to your account.
4. After this, your Smart Life App will be connected to your Google Speaker.
5. You can control the brightness via your Google Home App (Figure 4) and use voice control to change the colour of the device. Use voice commands such as "OK, Google, change the light to red" or "Ok Google, turn the brightness down".

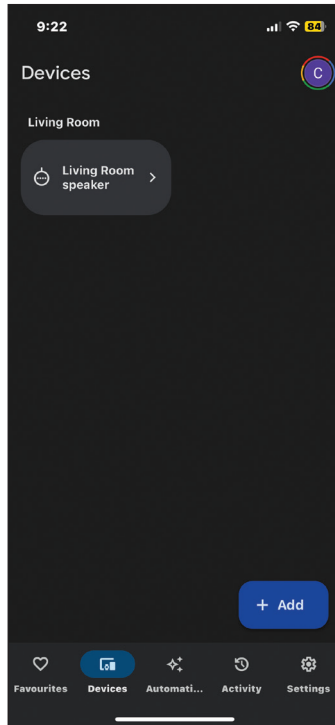

Figure 1

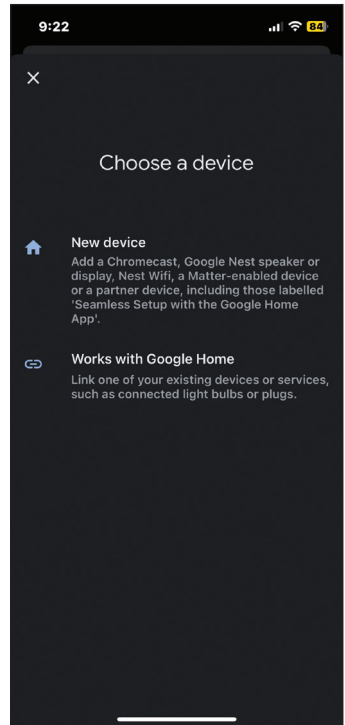

Figure 2

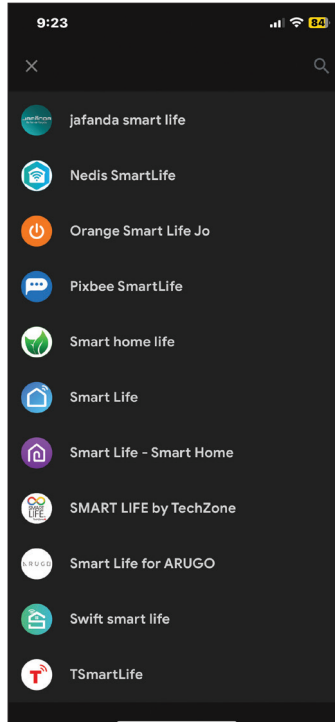

Figure 3



Figure 4

Troubleshooting

Situation	Solution
Can't turn the smart floor lamp on or off.	Make sure your phone and the Smart Floor Lamp are connected to the same Wi-Fi.
Configuration has failed.	<p>Make sure the smart floor lamp's red light is flashing twice per second.</p> <p>Make sure to connect your smart floor lamp within a short distance of your internet router.</p> <p>Check whether the available internet network has a frequency of 2.4 GHz.</p> <p>Check that your internet connection is working properly.</p>
How can I share devices with my family members?	Open the Smart Life app, select "profile" > "Devices Sharing"> "Sent," select "Add Sharing."
Can this app be used on any type of mobile phone? Can I control the device from a distance?	Yes, the app can work with both Android and iOS. systems. Once connected to the Internet, there is no distance limitation.
Can I control the devices with a 2G, 3G, or 4G connection?	The smart devices must be registered first on a Wi-Fi network; after you have successfully connected them, the smart floor lamp can be controlled by your smart phone with 2G, 3G, and 4G networks.
Will it cause a fire or other safety hazards if kept on all night?	No, it is safe to use all night.
Can I adjust the brightness on this?	Yes, you can adjust the brightness on the app.

Technical Support

If you require any technical support within the warranty period, please contact us on support@dmdcollective.co.uk and provide the product name and supplier code (see Technical Specifications) along with the technical query and proof of purchase.



The WEEE symbol  on this product means that this product should be ethically dismantled or recycled to minimise environmental impact. Please check with your local authority for more information.

Important: Additional Safety Information

This device is **NOT** intended for use by persons (including children) with reduced physical, sensory or mental capabilities or lack of experience and knowledge, unless they are supervised or have been given instruction concerning use of the device by a person responsible for their safety.

Technical Specifications

Product Name:	DMD Collective Smart Corner Lamp
Supplier Code:	DMD103BLK
Power Input:	12V 1A~2A(max)
Temperature:	Operating: -10°C~40°C RH≤80%, Storage: -20°C~70°C RH<80%
Wireless Type:	Wi-Fi 2.4GHz
Radio Technology:	IEEE 802.11B/G/N, Bluetooth 4.2
Shell Material:	Aluminium ABS+PC
Application:	Amazon Alexa, Google Home, Yandex Alice
App Support:	ISO 8.0 or Android 4.1 and higher
Product Warranty:	1 Year
Product Size:	10cm (W) x 10cm (D) x 146.5cm (H)
Delayer:	Countdown (time) off/on; Time setting: Time (0~23H), Minutes (1~59min)



For Product Support:

E: support@dmdcollective.co.uk

T: +44 (0)161 447 8597

www.dmdcollective.co.uk

UK Registered Address: The Ace Supply Co Ltd., Suite GA,
Marsland House, Marsland Road, Sale M33 3AQ

EU Registered Address: Ace Supply Co (Europe) Ltd.
25 Herbert Place, Dublin 2, D02 A098, Republic of Ireland